

# EXPLODED VIEW

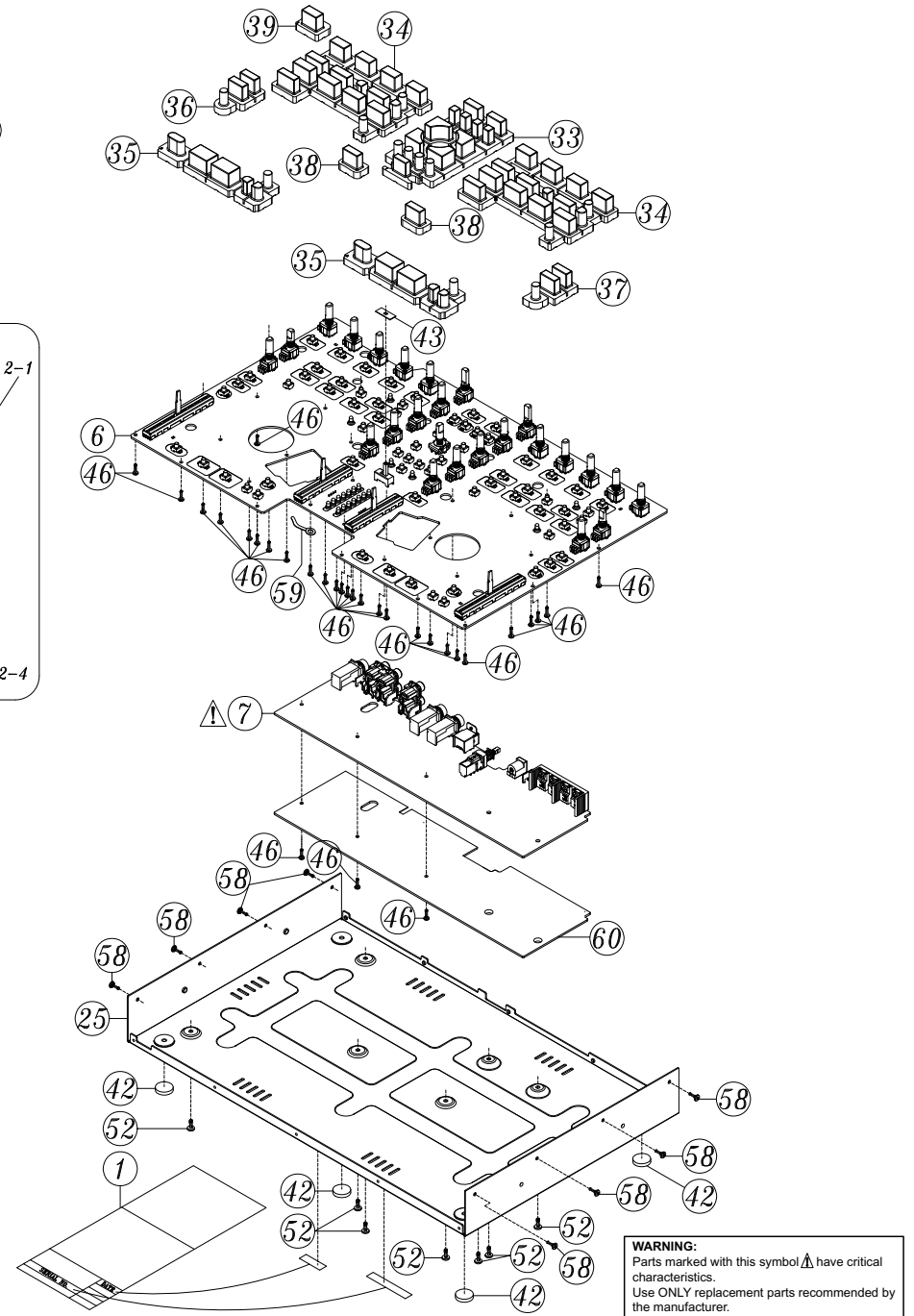

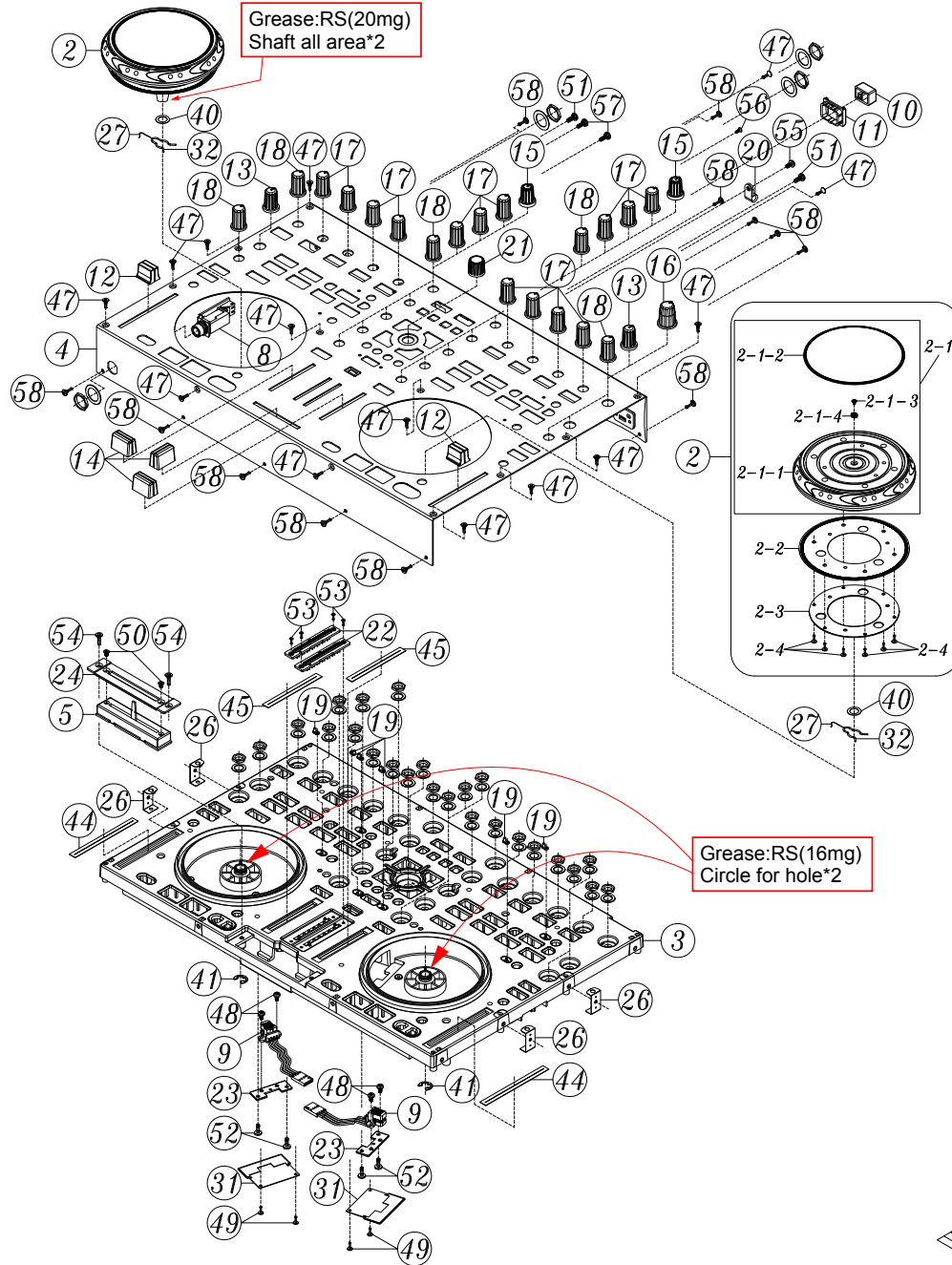

## PARTS LIST OF EXPLODED VIEW

\*Parts indicated by "nsp" on this table cannot be supplied.

\*P.W.B. ASS'Y indicated by "nsp" on this table cannot be supplied. When repairing the P.W.B. ASS'Y, check the board parts list and order replacement parts.

\*Parts indicated by the "★" mark are not illustrated in the exploded view.

\*The parts listed below are only for maintenance. Therefore they might differ from the parts used in the unit in appearances or dimensions.

**Note:** The symbols in the column "Remarks" indicate the following destinations.  
E3 : U.S.A. & Canada model                      E2 : Europe model

Ref. No.	Part No.	Part Name	Remarks		Q'ty	New
1	nsp	BAR CODE(86*209mm,t=0.1mm)	E2	701-3000E2-4916	1	
1	nsp	BAR CODE(86*209mm,t=0.1mm)	E3	701-3000E3-4916	1	
2	nsp	WHEEL ASS'Y		701-2000-4922	2	
2-1	941412004120P	WHEEL & PLATE ASS'Y		701-SC2000-4942	2	
2-1-1	nsp	WHEEL & SHAFT ASS'Y		701-2000-4815	2	
2-1-2	nsp	WHEEL PLATE		300-2000-1833	2	
2-1-3	nsp	SCWER(SAE1018,STS,2.0*3)		602-STS2003-677	2	
2-1-4	nsp	SPRING(SUS304, $\phi$ 0.3,L=6)		603-M1-384	2	
2-2	941483004110P	ENCODER PLATE		300-PROS2-848	2	
2-3	nsp	ENCODER FIXED PLATE		300-PROS2-851	2	
2-4	nsp	SCREW(PTB, $\phi$ 2*L6)		602-PROS2-363	12	
3	nsp	CHASSIS ASS'Y		701-3000-5072	1	
4	nsp	TOP PANEL ASS'Y		703-3000-1352	1	
5	nsp	CROS FADER PCB ASS'Y		704-6000-9603	1	
6	nsp	CONTROL PCB ASS'Y		704-3000-A021	1	
△	7	nsp	I/O PCB ASS'Y	704-3000-A023	1	
8	nsp	PHONE PCB ASS'Y		704-3000-A024	1	
9	nsp	SENSOR PCB ASS'Y		704-3000-A082	2	
10	00D9410057301	POWER KNOB		100-HDJ2000-1641	1	
11	90M09CW259020	KNOB PROTECTOR		100-HDJ2000-1642	1	
12	941412005080P	PUSH KNOB(MIDDLE)		100-UDJ3EB-2213	2	
13	00D9587012907	ROTARY KNOB(ABS,BLACK)		100-300-2226	2	
14	00D9587013401	PUSH KNOB		100-300-2231	3	
15	00D9587045709	ROTARY KNOB(PP WHITE,TPR BLACK)		100-900-2298	8	
16	412510031005P	ROTARY KNOB		100-1100-2633	1	
17	412510032008P	ROTARY KNOB		100-1100-2634	14	
18	941412005100P	ROTARY KNOB		100-6000-2634	5	
19	nsp	LED LENS		100-700-2680	6	
20	nsp	CABLE CLAMP(PC-1S)		100-K1-2682	1	
21	941412003130P	JOG TUNING KNOB		100-1000S-2736	1	
22	nsp	LED LENS		100-3000-2865	2	
23	nsp	SENSOR FIXED PLATE(SECC,1.2t)		300-HDJ9800-981	2	
24	nsp	FIXED PLATE FOR SLIDE VR(SECC,1.5t)		300-100-1167	1	
25	nsp	BASE		300-3000-1922	1	
26	nsp	GROUND PLATE		300-3000-1953	4	
27	nsp	1P LEAD WIRE(L=45mm,AWM1007 AWG26)		406-PS2-631	2	
31	nsp	DUST-PROOF SLICE		501-HDJ9800-1648	2	
32	nsp	CLIP		603-PROS2-256A	2	
33	941411101650P	MASTER SOFT KNOB		604-3000-582	1	*
34	941411101640P	EFX SOFT KNOB		604-3000-583	2	*
35	941411101590P	PLAY/CUE SOFT KNOB		604-3000-584	2	*
36	941411101600P	DECK/AC SOFT KNOB		604-3000-585	1	*
37	941411101610P	DECK/BD SOFT KNOB		604-3000-586	1	*
38	941411101620P	CUE SOFT KNOB		604-3000-587	2	*
39	941411101630P	DUCKING SOFT KNOB		604-3000-588	1	*

Ref. No.	Part No.	Part Name	Remarks		Q'ty	New
40	nsp	PULLEY WASHER( $\phi$ 11.6*76*0.25t)		606-F200-003	2	
41	nsp	E RING		606-DJ3000-105	2	
42	nsp	FOOT(PORON,BLACK, $\phi$ 15*3t)		612-HV3500K-055	4	
43	nsp	CUSHION(17*7*0.5t,BLACK)		612-900-219	1	
44	nsp	CUSHION(75*7*0.3t,BLACK)		612-IMR-295	2	
45	nsp	CUSHION(64*7*0.3t,BLACK)		612-IM-296	2	
60	nsp	ISOLATION SHEET(PC,0.5t)		501-3000-2487	1	*
<b>SCREWS</b>						
46	nsp	SCREW(SAE1018,PTP,M2.6*L8)		602-SL24F-099	31	
47	nsp	SCREW( $\phi$ 5,L=8)		602-HP1010K-182	14	
48	nsp	SCREW(SAE1018,CTP, $\phi$ 3*5L*P0.5)		602-MP3-324	4	
49	nsp	SCREW(PTB, $\phi$ 2*L6)		602-PROS2-363	4	
50	nsp	SCREW(SAE1018,ISOF, $\phi$ 3*L4*P0.5)		602-SA12-414	2	
51	nsp	SCREW(STB,3*8,ZB)		602-DCM280-429	2	
52	nsp	SCREW(SAE1018,PTB, $\phi$ 3*L8)		602-DJ5500-452	11	
53	nsp	SCREW(BTP,2*5,MC)		602-A700-494	4	
54	nsp	SCREW(SAE1018,PTF,M3*L10*P1.27)		602-PTF3010-585	2	
55	nsp	SCREW(SAE1018,WISO,M3*6,CAP $\phi$ 6)		602-WISO3006-652B	1	
56	nsp	SCREW(C1018,ISOF,M2*5)		602-ISOF2005-686B	1	
57	nsp	SCREW(SAE1018,BTB,3*8)		602-BTB3008-706B	2	
58	nsp	SCREW(SAE1018,BTB, $\phi$ 2.6,L=8)		602-BTB2608-708B	20	
59	nsp	WINDING FIXTURE(SPTE t=0.3 WC-1A)		300-HM510B-224	1	